

串联隔膜阀

SERIES DIAPHRAGM VALVE

串联阀有各种不同的角度和位置可供选择。串联阀有锻造材质或毛坯材质可供选择（如图所示）。

Series valves are available in a variety of different angles and positions. The series valve has a forged material or a blank material to choose (as shown in figure).

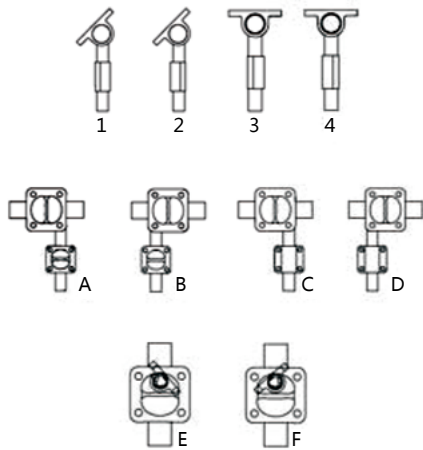

主阀水平自排尽安装，支阀左侧垂直安装



主阀水平自排尽安装，支阀右侧垂直安装



主阀水平向上安装，支阀右（左）侧垂直安装



主阀水平自排尽安装，支阀左侧倒水平自排尽安装



主阀垂直安装，支阀上部水平自排尽安装

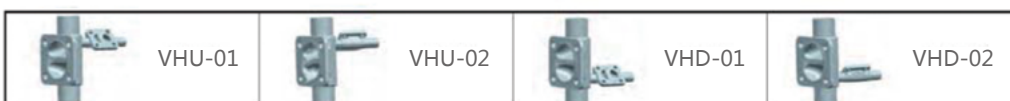



直通阀底的尺寸 STRAIGHT VALVE BOTTOM SIZE

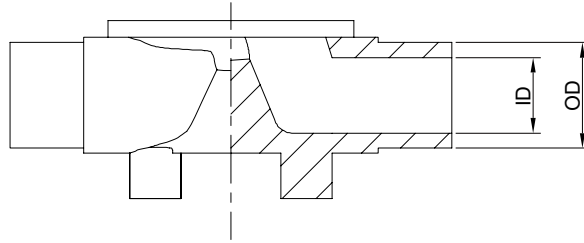

焊式 (mm)

No.KST220-1

SIZE	ISO		3A/BPE		DIN		BS	
	OD	ID	OD	ID	OD	ID	OD	ID
DN8	12.7	9.4	-	-	11	8	-	-
DN10	12.7	9.4	-	-	13	10	-	-
DN15	12.7	9.4	12.7	9.4	18	15	12.7	9.5
DN20	19.1	15.8	19.1	15.8	22	19	19.1	15.9
DN25	25	22.6	25.4	22.1	28	25	25.4	22.2
DN32	-	-	-	-	35	32	-	-
DN40	38	35.6	38.1	34.8	40	37	38.1	34.9
DN50	51	48.6	50.8	47.5	52	49	50.8	47.6
DN65	63.5	60.3	63.5	60.2	70	66	63.5	60.3
DN80	76.1	72.9	76.2	72.9	85	81	76.2	73

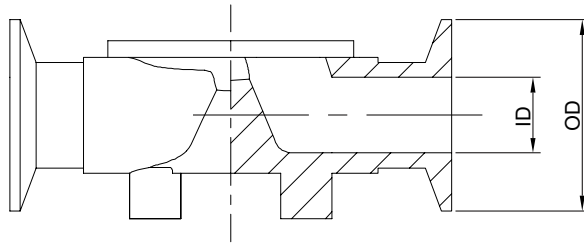

焊式 (mm)

No.KST220-3

SIZE	ISO		3A/BPE		DIN		BS	
	OD	ID	OD	ID	OD	ID	OD	ID
DN8	25	9.4	-	-	34	8	-	-
DN10	25	9.4	-	-	34	10	-	-
DN15	25	9.4	25	9.4	34	15	25	9.5
DN20	25	15.8	25	15.8	34	19	25	15.9
DN25	50.5	22.6	50.4	22.1	50.5	25	50.5	22.2
DN32	-	-	-	-	50.5	32	-	-
DN40	50.5	35.6	50.4	34.8	50.5	37	50.5	34.9
DN50	64	48.6	63.9	47.5	64	49	64	47.6
DN65	77.5	60.3	77.5	60.2	91	66	77.5	60.3
DN80	91	72.9	90.9	72.9	106	81	91	73